

OPERATING INSTRUCTIONS FOR THE ELECTRIC SOLDERING IRON

MODEL

- LI 230 (without soldering tip and stand).
- LI 230 b (Incl. soldering tip "B" and stand).



This manual contains important safety and operating instructions concerning the use of the soldering iron. Please keep these instructions in a safe and accessible place.



Improper use of the soldering iron can be dangerous. For safe use, please read and comply with the following measures.

Safety regulations-

1. The soldering iron is not to come into contact with water or any other fluid.
2. Avoid damage to the cable:
 - a. Do not pull on the cable with the soldering iron.
 - b. The power plug is not to be pulled out by the cable.
3. Protect the cable from sharp edges, oil and heat.
4. When not in use, the power plug is to be removed from the power supply.
5. During inspection, maintenance or repairs, the power plug has to remain disconnected from the power supply.
6. Please ensure that no mountings, coverings or screws are removed which could affect the operational use and/or create a safety hazard.
7. Only the original soldering tips may be used with the soldering iron. Do not work without a soldering tip on the soldering iron.
8. **On completion of your soldering, place the soldering iron in a warm and dry spot to cool down.**

Spare parts.

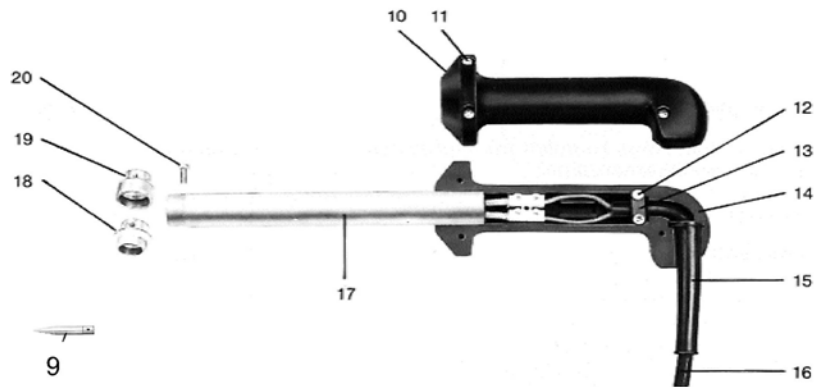

	Part description	Article - Nr.
09	Soldering tip, Brass	38-0353000
10	Plastic handle (upper part)	19-0232001
11	Screw 4 x 25 (3 pcs.)	9040002500042
12 *	Screw 3,5 x 13 (2 pcs.)	9035001362122
13 *	Cable clip	19-0232004
14	Plastic handle (lower part)	19-0232005
15	Rubber grommet	59-0020213
16	Power cable with plug 220 Volt	19-0232007
17	Heating unit 230 Volt compl.	19-0232009
18	Soldering tip A (13 x 16 mm)	19-0230016
19	Soldering tip B (17,5 x 19,5 mm)	19-0230015
20	Cyl.-screw 4 x 10 VA (2 pcs.)	9004001201081
Not illust.	Soldering iron stand V 2 a	13-0232200

* No longer in programm as of 08.2010.

Soldering iron precautions.

1. Only the voltage as stipulated on the name plate is to be used when soldering.
2. The soldering iron is to be stored in safe place on completion of the soldering.
3. The storage of the soldering iron has to be outside the reach of animals, inflammable goods and the storage room has to be dry.
4. Before heating up the soldering iron, ensure that the soldering tip is correctly seated and screwed tight.
5. **Never place the soldering iron in fluids i.e. water to cool down!**
6. The soldering iron must be kept at a distance of 30 cm from walls and 50 cm from ceilings.
7. The replacement of a soldering tip is only to be carried out when the soldering iron is cold.
8. Do not attempt to open the soldering iron or carry out any repairs.

General instructions and procedures.

1. Children are not to be present and should be kept away whilst you are soldering.
2. Never work with a faulty or defective soldering iron. Should you detect that there has been damage in any kind to the housing or electric cable, the soldering iron is then to be sent back for repair to the manufacturer, one of his service centres or to a qualified electrician.
3. Never carry out soldering within the proximity of explosive substances, gasses or objects.
4. Never solder without a tip or with a worn out soldering tip.
5. Ensure that you do not come into contact with a heated soldering tip.
6. The soldering iron should always be stored in a clean and dry place which is non-accessible for children and animals.

Specific Requirements

1. Means of application

The soldering iron should only be used for the purpose of soldering.

2. Implementation

After a heating up period of 7 minutes has elapsed, the soldering iron should now be ready for use. To test this, press the soldering tip against a piece of wood, this will cause a black burn mark to form. The soldering iron is now ready to use.

Technical details

Soldering iron LI 230 + LI 230b: 230 Volt 190 Watt

Mounting the soldering iron stand.

(Only for model LI 230 b)



1. As shown in the photograph above, gently squeeze the handle ends of the stand towards each other so that the eyelet of the stand can slide over the barrel of the soldering iron.
2. Adjust the stand on the barrel of the soldering iron in such a manner so as to ensure that the soldering iron can stand safely on it's own and that the heated soldering tip will not come into contact with the resting surface.

1. Environmental protection and disposal

After the service life of the appliance, it is the operator's responsibility to safely dispose of the soldering iron in a proper and environmental manner. Please pay attention and comply with the environmental regulations in force in your country.

Declaration of conformity.

This appliance conforms to the requirements of the following EU-Regulations:
2004/108/EG
2006/95/EG

Supplier

Jørgen Kruuse A/S
Havretoften 4

Tel: +45 7214 1511
Fax: +45 7214 1600

DK-5550 Langeskov, Denmark

e-mail: info@kruuse.com